

From Eye to Insight

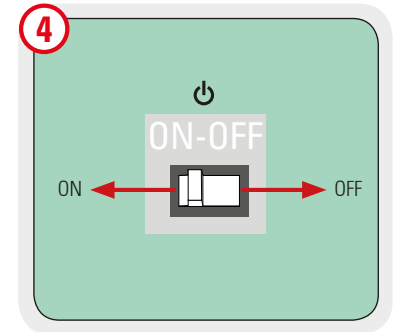
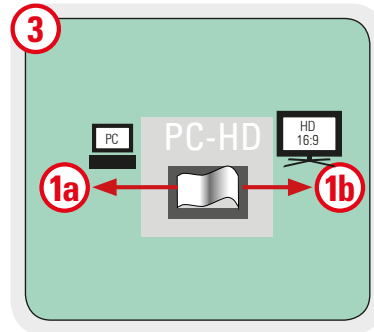
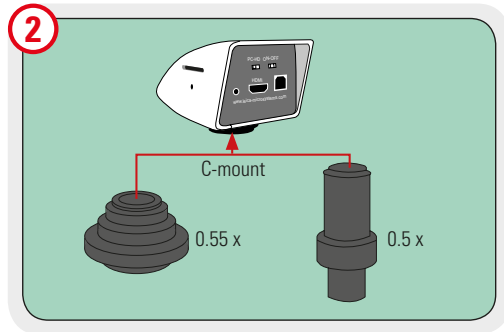
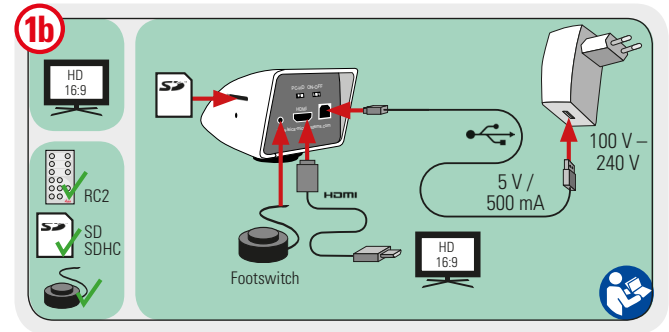
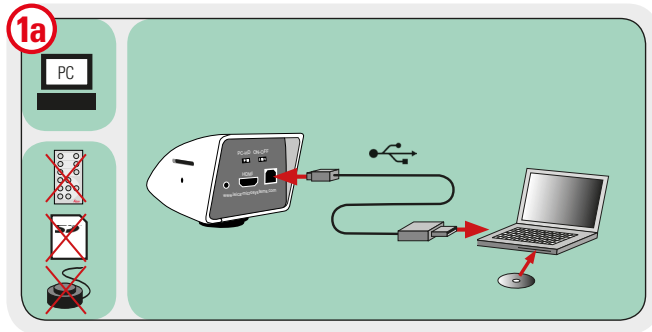

Remote Control RC2: Quick Start Guide

1. Switch camera to HD mode

PC - HD



2. Turn ON the camera

ON - OFF



3. Please read the manual for further instruction



IR-Receiver

Battery Type

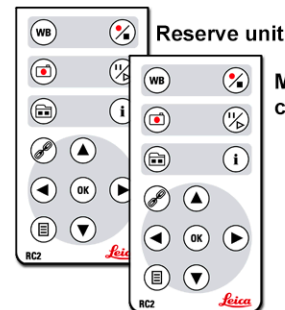

Reserve unit

Main remote control unit

Set White Balance

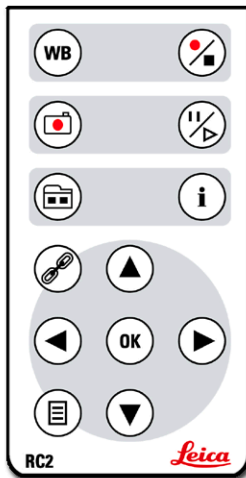

Start / Stop movie rec

Save Image to SD card

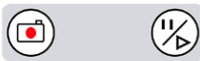

Pause / Play

Show / Hide Gallery

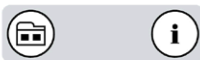

Show / Hide Info-Box

Pairing



Next / Previous Overlay

OK: Confirm / Zoom / Start playback

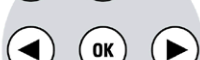

Next / Previous Illum. Mode

Show Menu



PAIRING REMOTE WITH CAMERAS

To PAIR:

1. Press the pairing button 
2. Press and hold desired channel button, e.g. 01 (WB)
3. Wait for confirmation

To RESET:

1. Press the pairing button
2. Press and hold channel 01
3. Wait for confirmation

To EXIT:

Press the pairing button 

